



**Electrical Helper.org**  
 For All Your Electric Needs Since 1928  
 411 N Platte Ave. York, NE. 68467

AC-DC MOTORS :: SALES & SERVICE  
 REWINDING :: CUSTOM CONTROL PANEL

Kelly MacMillan  
 Office Ph: 888-226-4917  
 Fax: 888-226-4917  
 Cell: 402-679-1579  
 E-Mail: kelly@electricalhelper.com



# DATA SHEET

Premium Efficiency Motor: **NT1-36-56CB**

**60 Hz**

Document Generated: 5-Sep-2023

Document ID:

Customer:

## MOTOR INFORMATION

HP	1
RPM	3600
Phase	1
Frequency	60 Hz
Voltage	115/230
Frame Size	56C
Enclosure	TEFC
Degree of Protection	IP43
Service Factor	1.15
Poles	2
Full Load	3450
Speed	F
Temperature Class	80°C
NEMA Code Letter	M
Duty Cycle	S1 / Continuous
Slip	4.17%
Max Ambient Temperature	40°C
Max Elevation	1000 m.a.s.l (3300 f.a.s.l)
Mounting	F1
Rotation	Bi-Directional
Mounting Type	C-Face with Removable Base
Standard	NEMA MG-1
Approvals	CSA, CE
Overload	None

## EFFICIENCY/POWER FACTOR

LOAD	EFF	P. F.
100%	71.5	
%	81.27%	74.8
50%	65.3 %	63.

## TORQUE

FULL LOAD	LRT	BDT
1.53 lb.ft.	295 %	230

## AMPERAGE INFORMATION

	115V	230V
Full Load Amps	11.5	5.8
Locked Rotor Amps	85.7	42.8
No Load Current	6.09	3.045
Usable at 208V	6.3A	

## BEARING INFORMATION

DE Bearing	6203 2RS
ODE	6203 2RS

Bearing

## CAPACITOR INFORMATION

Start	(1)500uF/165V
Capacitor Run	--

Capacitor

## ADDITIONAL DATA

F2 Suitable	No
Shaft Material	1045 Carbon
Connection Diagram	Steel 115/230V -
Approximate Weight	6 Lead

30 lbs.



**Electrical Helper.org**  
 For All Your Electric Needs Since 1928  
 411 N Platte Ave. York, NE. 68467

AC-DC MOTORS :: SALES & SERVICE  
 REWINDING :: CUSTOM CONTROL PANEL  
 Kelly MacMillan  
 Office Ph: 888-226-4917  
 Fax: 888-226-4917  
 Cell: 402-679-1579  
 E-Mail: kelly@electricalhelper.com



# MOTOR DRAWING

Premium Efficiency Motor: **NT1-36-56CB**

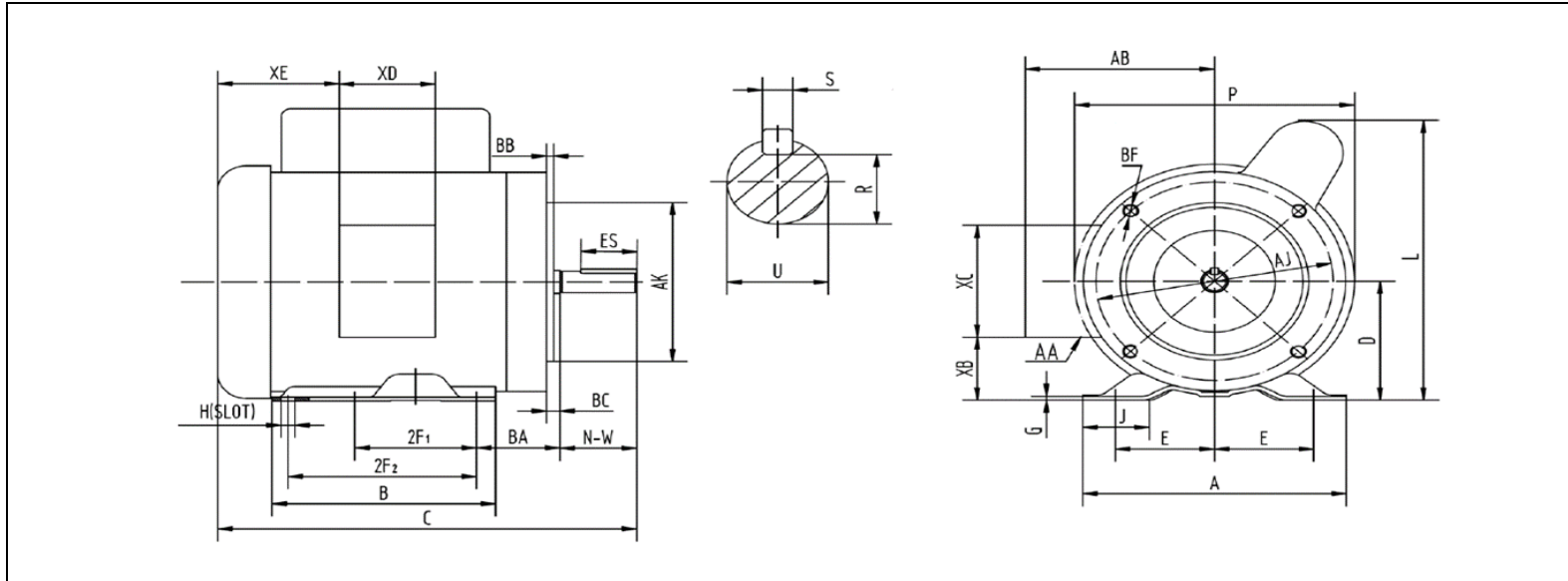

## DIMENSION - INCHES

MOUNTING					A	B	C	D	G	L	P	AB	J
E	2F1	2F2	H	BA									
2.44	3	5	0.34	2.75	6.54	6.54	12.4	3.5	0.12	8.2	7.3	5.2	1.65

SHAFT & KEY				
R	ES	S	U	NW
0.517	1.41	0.188	0.625	1.88

TERMINAL BOX				
XB	XC	XD	XE	AA
1.65	3.7	3.2	2.15	3-0.88/2-1.109

FLANGE				
AK	AJ	BF	BB	BC
4.5	5.875	3/8-16	0.16	-0.19



Electrical Helper.org

For All Your Electric Needs Since 1928  
411 N Platte Ave. York, NE. 68467

AC-DC MOTORS :: SALES & SERVICE  
REWINDING :: CUSTOM CONTROL PANEL

Kelly MacMillan  
Office Ph: 888-226-4917  
Fax: 888-226-4917  
Cell: 402-679-1579  
E-Mail: kelly@electricalhelper.com



# NAMEPLATE / WIRING

Premium Efficiency Motor: **NT1-36-56CB**

Document Generated: 5-Sep-2023  
Document ID:

Customer:

## SAMPLE NAMEPLATE DATA

		SINGLE PHASE INDUCTION MOTOR					
MODEL	FRAME 56C	LOW VOLTAGE		HIGH VOLTAGE		MADE IN CHINA	
Hz 60	ENCL. TEFC	BLUE (T1)	] LINE1	BLUE (T1)	LINE1		
HP	PH 1	ORANGE (T3)		ORANGE (T3)	] INS		
RPM	DUTY CONT	RED (T8)	RED (T8)				
VOLTS 115/230	CODE	WHITE (T2)	] LINE2	WHITE (T2)	] LINE2		
AMPS	INS. F IP43	YELLOW (T4)		YELLOW (T4)			
	DES.	BLACK (T5)	BLACK (T5)				
S. F. 1.15	LB/WT	ACCEPTABLE FOR FIELD WIRING					
SFA.	MAX. AMB. 40°C	ROTATION CCV-OPE TO REVERSE EITHER VOLTAGE					
DE/ODE BRG.	Date Code XX/XXXXX	INTERCHANGE BLACK (T5) AND RED (T8) LEADS					
SERIAL NO. XXXXXXXXXXXX		THERMALLY PROTECTED : NONE					
WorldWide Electric Corporation							

<b>Model</b>	NT1-36-			
56CB	<b>Frame</b>	56C Hz	Encl	60 HÆFC
<b>HP</b>	1		<b>PH</b>	1
<b>RPM</b>	3450		<b>DUTY</b>	CONT
<b>Voltage</b>	115/230		<b>Code</b>	M
<b>Amps</b>	11.5/5.8		<b>Ins Cl</b>	F
<b>S.F.</b>	1.15		<b>IP</b>	IP43
<b>SFA.</b>	12.4/6.2		<b>DES.</b>	N
<b>DE Brng</b>	6203 2RS		<b>WT:</b>	30
lbs. <b>ODE Brng</b>	6203 2RS			