



DATA SHEET

Premium Efficiency Motor: **NT34-36-56CB**

60 Hz

Document Generated: 5-Sep-2023

Document ID:

Customer:

MOTOR INFORMATION

HP	3/4
RPM	3600
Phase	1
Frequency	60 Hz
Voltage	115/230
Frame Size	56C
Enclosure	TEFC
Degree of Protection	IP43
Service Factor	1.15
Poles	2
Full Load	3450
Speed	F
Temperature Class	80°C
NEMA Code Letter	M
Duty Cycle	S1 / Continuous
Slip	4.17%
Max Ambient Temperature	40°C
Max Elevation	1000 m.a.s.l (3300 f.a.s.l)
Mounting	F1
Rotation	Bi-Directional
Mounting Type	C-Face with Removable Base
Standard	NEMA MG-1
Approvals	CSA, CE
Overload	None

EFFICIENCY/POWER FACTOR

LOAD	EFF	P. F.
100%	69.4 %	76.7
75%	66.4 %	69.7
50%	59.9 %	59.2

TORQUE

FULL LOAD	LRT	BDT
1.12 lb.ft.	290 %	295 %

AMPERAGE INFORMATION

	115V	230V
Full Load Amps	9.2	4.6
Locked Rotor Amps	69.0	34.5
No Load Current	5.65	2.825
Usable at 208V	4.9A	

BEARING INFORMATION

DE Bearing	6203 2RS
ODE	6203 2RS

Bearing

CAPACITOR INFORMATION

Start	(1)400uF/165V
Capacitor Run	--

Capacitor

ADDITIONAL DATA

F2 Suitable	No
Shaft Material	1045 Carbon
Connection Diagram	Steel 115/230V -
Approximate Weight	6 Lead

27 lbs.

MOTOR DRAWING

Premium Efficiency Motor: **NT34-36-56CB**



Electrical Helper.org
For All Your Electric Needs Since 1928
411 N Platte Ave. York, NE. 68467

AC-DC MOTORS :: SALES & SERVICE
REWINDING :: CUSTOM CONTROL PANEL

Kelly MacMillan
Office Ph: 888-226-4917
Fax: 888-226-4917
Cell: 402-679-1579
E-Mail: kelly@electricalhelper.com

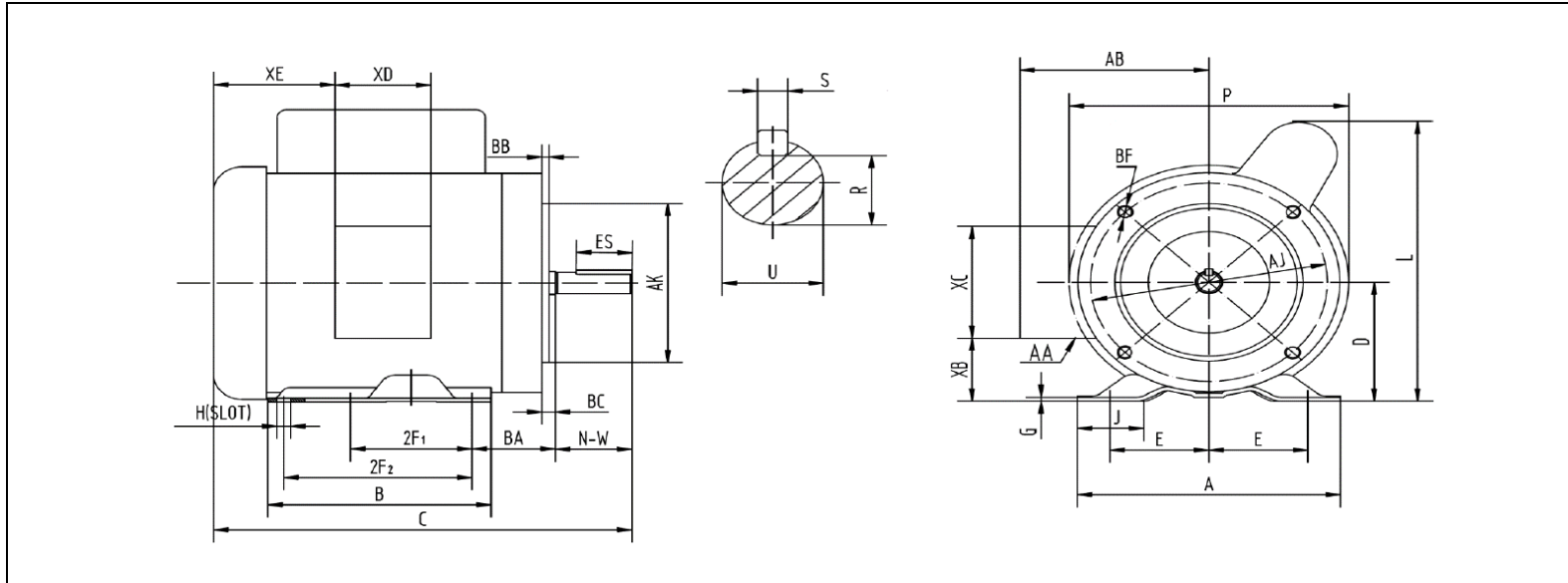

DIMENSION - INCHES

MOUNTING					A	B	C	D	G	L	P	AB	J
E	2F1	2F2	H	BA									
2.44	3	5	0.34	2.75	6.54	6.54	11.9	3.5	0.12	8.2	7.3	5.2	1.65

SHAFT & KEY				
R	ES	S	U	NW
0.517	1.41	0.188	0.625	1.88

TERMINAL BOX				
XB	XC	XD	XE	AA
1.65	3.7	3.2	2.15	3-0.88/2-1.109

FLANGE				
AK	AJ	BF	BB	BC
4.5	5.875	3/8-16	0.16	-0.19



Electrical Helper.org

For All Your Electric Needs Since 1928
411 N Platte Ave. York, NE. 68467

AC-DC MOTORS :: SALES & SERVICE
REWINDING :: CUSTOM CONTROL PANEL

Kelly MacMillan
Office Ph: 888-226-4917
Fax: 888-226-4917
Cell: 402-679-1579
E-Mail: kelly@electricalhelper.com



NAMEPLATE / WIRING

Premium Efficiency Motor: **NT34-36-56CB**

Document Generated: 5-Sep-2023

Document ID:

Customer:

SAMPLE NAMEPLATE DATA

		SINGLE PHASE INDUCTION MOTOR			
MODEL	FRAME 56C	LOW VOLTAGE		HIGH VOLTAGE	
Hz 60	ENCL. TEFC	BLUE (T1)] LINE1	BLUE (T1)	LINE1
HP	PH 1	ORANGE (T3)		ORANGE (T3)] INS
RPM	DUTY CONT	RED (T8)] LINE2	RED (T8)	
VOLTS 115/230	CODE	WHITE (T2)		WHITE (T2)	
AMPS	INS. F IP43	YELLOW (T4)	YELLOW (T4)	BLACK (T5)	BLACK (T5)
	DES.	BLACK (T5)			
S. F. 1.15	LB/WT	ACCEPTABLE FOR FIELD WIRING			
SFA.	MAX. AMB. 40°C	ROTATION CCV-OPE TO REVERSE EITHER VOLTAGE			
DE/ODE BRG.	Date Code XX/XXXXX	INTERCHANGE BLACK (T5) AND RED (T8) LEADS			
		THERMALLY PROTECTED : NONE			
SERIAL NO. XXXXXXXXXXXX		WorldWide Electric Corporation			

MADE IN CHINA

Model	NT34-36-56CB	Frame	56C Hz	Encl	60 Hz TEFC
HP	3/4	PH	1	DUTY	CONT
RPM	3450	Code	M	Ins Cl	F
Voltage	115/230	IP	IP43	DES.	N
Amps	9.2/4.6	WT:	27		
S.F.	1.15				
SFA.	10.0/5.0				
DE Brng	6203 2RS				
lbs. ODE Brng	6203 2RS				